



Norwich Drive, Brighton, BN2 4LG
Offers In The Region Of £300,000



**GOLDIN
LEMCKE**

01273 777123
GOLDINLEMCKE.COM

SELLING HOMES
IN BRIGHTON
& HOVE
SINCE 2002

Norwich Drive, Brighton, BN2 4LG

Offers In The Region Of £300,000

A three-bedroom semi-detached house set in a quiet residential position in Brighton, offering a good-sized rear garden and plenty of scope for improvement. The property would benefit from modernisation throughout but presents a great opportunity to create an excellent family home.





Further Information

The accommodation comprises on the ground floor a bathroom and two double bedrooms, one of which features sliding doors opening directly onto the rear garden. There is a further bedroom on the split-level landing, while the first floor offers a spacious open plan kitchen/dining room and a bright dual aspect living room.

To the rear, there is an excellent sized garden, providing plenty of outdoor space.

Situated in a well-connected residential pocket of Brighton, Norwich Drive offers a practical setting for day-to-day living. Nearby transport links provide straightforward access into the city centre and towards London, while a range of local shops, cafés and amenities can be found within the surrounding area. Well-regarded schools are also close by, making the location a popular choice for families and professionals alike.



GOLDINLEMCKE

01273 777123
GOLDINLEMCKE.COM

Norwich Drive

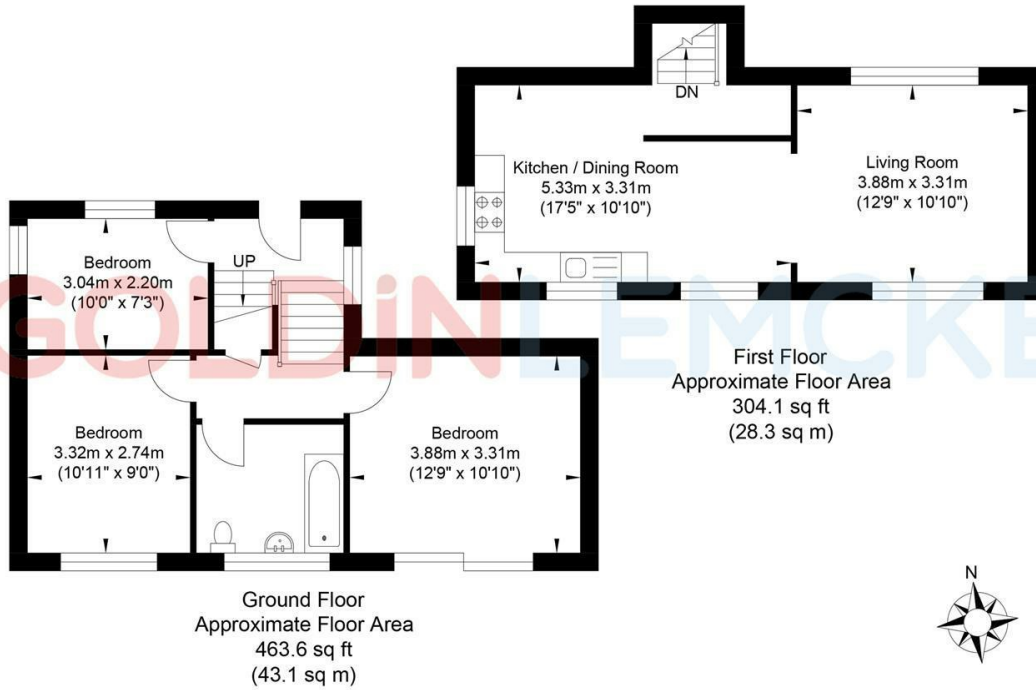

Approximate Gross Internal Area = 71.4 sq m / 767.7 sq ft
Illustration for identification purposes only, measurements are approximate, not to scale.



GOLDIN LEMCKE
01273 777123
GOLDINLEMCKE.COM

SELLING SOMETHING SIMILAR?

Get in touch for a free, no obligation valuation.
Call 01273 777123 or email property@goldinlemcke.com

| Energy Efficiency Rating | | Current | Potential |
|---|--|-------------------------|-----------|
| Very energy efficient - lower running costs | | | |
| (92 plus) A | | | |
| (81-91) B | | | |
| (69-80) C | | | |
| (55-68) D | | 64 | 79 |
| (39-54) E | | | |
| (21-38) F | | | |
| (1-20) G | | | |
| Not energy efficient - higher running costs | | | |
| England & Wales | | EU Directive 2002/91/EC | |

SELLING HOMES
IN BRIGHTON
& HOVE
SINCE 2002

The above information has been provided by the vendor in good faith, but will need verification by the purchaser's solicitor. Any areas, measurements or distances referred to are given as a guide only and are not precise. Floor plans are not drawn to scale and are provided only to help illustrate the general layout of the property. The mention of any appliances and/or services in this description does not imply that they are in full and efficient working order and prospective purchasers should make their own investigations before finalising any agreement to purchase. It should not be assumed that any contents, furnishings or other items shown in photographs (which may have been taken with a wide angle lens) are included in the sale. Any reference to alterations to, or use of, any part of the property is not a statement that the necessary planning, building regulations, listed buildings or other consents have been obtained. We endeavour to make our details accurate and reliable, but they should not be relied on as statements or representations of fact and they do not constitute any part of an offer or contract. The seller does not give any warranty in relation to the property and we have no authority to do so on their behalf.